

**GRUNDY COUNTY HEALTH DEPARTMENT
ENVIRONMENTAL HEALTH DIVISION
1320 UNION STREET
MORRIS, IL. 60450
(815) 941-3404**

This Department is happy to provide the following information to assist you in planning and locating your Private Sewage Disposal (PSD) and water systems.

Malfunctioning PSD systems can lead to transmittal of diseases such as infectious hepatitis, gastroenteritis, dysentery, typhoid fever and cholera, pollution of surrounding lakes and streams, or declining property value due to odorous, nuisance conditions for your family and your neighborhood

Your water system must be properly located and constructed. Improperly located or constructed wells can contaminate the underground aquifers that not only supply water to your family but to your neighbors as well.

MINIMUM LATERAL DISTANCES OF A POTABLE WATER WELL AND PSD SYSTEM

Component Part of System	Well or Suction Line from Pump to Well	Water Supply Line (Pressure)	In-ground Swimming Pool, Lake, Stream or other body of water	Dwelling / Building / Permanent Structure (Pits, Crawlspace, or Basements)	Property Line	Field Tile / Artificial Drain	Ejector Sump
Feet	Feet	Feet	Feet	Feet	Feet	Feet	Feet
Building Sewer	=50	=10	=25	----	=10	----	----
Septic Tank or Aerobic Unit	=50	=10	=25	=10	=10	=10	----
Distribution Box	=75	=10	=25	=10	=10	=10	----
Subsurface Seepage Field or Sandfilter	=75	=25	=25	=10	=10	=25	----
Well or Suction Line	----	----	=25	=2 (=5)	=10	=10	=25

*** These distances are for clay and loam soils only. The distances for sand and other types of soil shall be determined by the Health Department.**

1. With a copy of your building plans and a survey of your lot, fill in as many of the items on the application as possible.
2. On the final page of the application, draw a scaled diagram of your lot, house sewer line, home and other proposed structures. Please include distances to all lot lines. Show any and all buried utility lines and easements. (Be as accurate as you can, since this will become your septic and well permit and also a permanent record on file and will be used by your contractor when installing the system.) You should be able to complete everything except the area titled as septic system. This section will be completed by your septic contractor after they receive the soil report Incomplete or poor diagrams will be NOT be accepted.
3. At your lot, a current soil evaluation must be conducted by a Soil Classifier of the ISCA or ARCPACS. A list of qualified individuals can be obtained from this office. The soil evaluation gives you and our staff an appraisal of your soil's absorption capacity as well as specific characteristics of the soil. The Subdivision Ordinance has additional regulations for PSD systems in new subdivisions. The Health Department is discouraging surface discharge systems because an E.P.A. discharge permit and annual testing may be required in the near future.
4. The homeowner, septic contractor, and well contractor must complete the application. Be sure to fill in the PIN# or tax I.D. # (if a PIN# has not been assigned, indicate if you are using a partial PIN#). Have your well contractor sign the well portion of the application.
5. When the application is completed and before the permit is issued the applicable permit fees must be paid. When your permit application is approved by one of our staff, you will receive up to three copies of the permit.
6. The white and pink copies of your application will be used by the Health Department. Take the yellow copy to the Building Department to get your building permit. The green copy is for you. (We suggest that you keep this with your other important documents).
7. Contact the Health Department to schedule an appointment 48 hours prior to the PSD system and/or well being ready for inspection. A bacteria free water test and nitrate test must be submitted to the Health Department, as well as the well construction report, before your home can be occupied. Neither a final approval nor occupancy will be granted by the Building Department prior to this Department issuing the final approval of the well and septic systems.
8. Contact the Health Department for information regarding the maintenance of your PSD and water supply systems. Since the life of your PSD system depends on how it is maintained, proper maintenance can make it last longer. The septic tank or aerobic tank must be maintained and pumped periodically. Your drinking water should be tested every year. Sample bottles can be obtained at the Health Department.

IN ORDER TO SAVE YOU TIME AND ENSURE THAT OUR STAFF WILL BE AVAILABLE TO TALK WITH YOU, PLEASE CALL THE HEALTH DEPARTMENT TO SCHEDULE ANY MEETINGS AT (815) 941-3115.

WELL AND SEPTIC FEES

PSD SYSTEMS

Aerobic Systems	\$300.00
New Septic System	\$250.00
Septic Repair	\$200.00
Site Inspection	\$50.00
Feasibility Letter	\$15.00
Variance Request Review	\$25.00

WATER SYSTEMS

New Well	\$100.00
Well Deepening	\$100.00
Well Modification	\$50.00
Well Inspection	\$100.00

Proposed **to scale** diagram needs to show house, lot lines, future buildings, proposed well site, septic tank site, surrounding wells and septic systems, easements, water line locations and all farm tile. Farm tile/drains to be at least 25 feet from septic fields in clay and clay loam soils. Please do a neat diagram **to scale** to prevent any confusion.

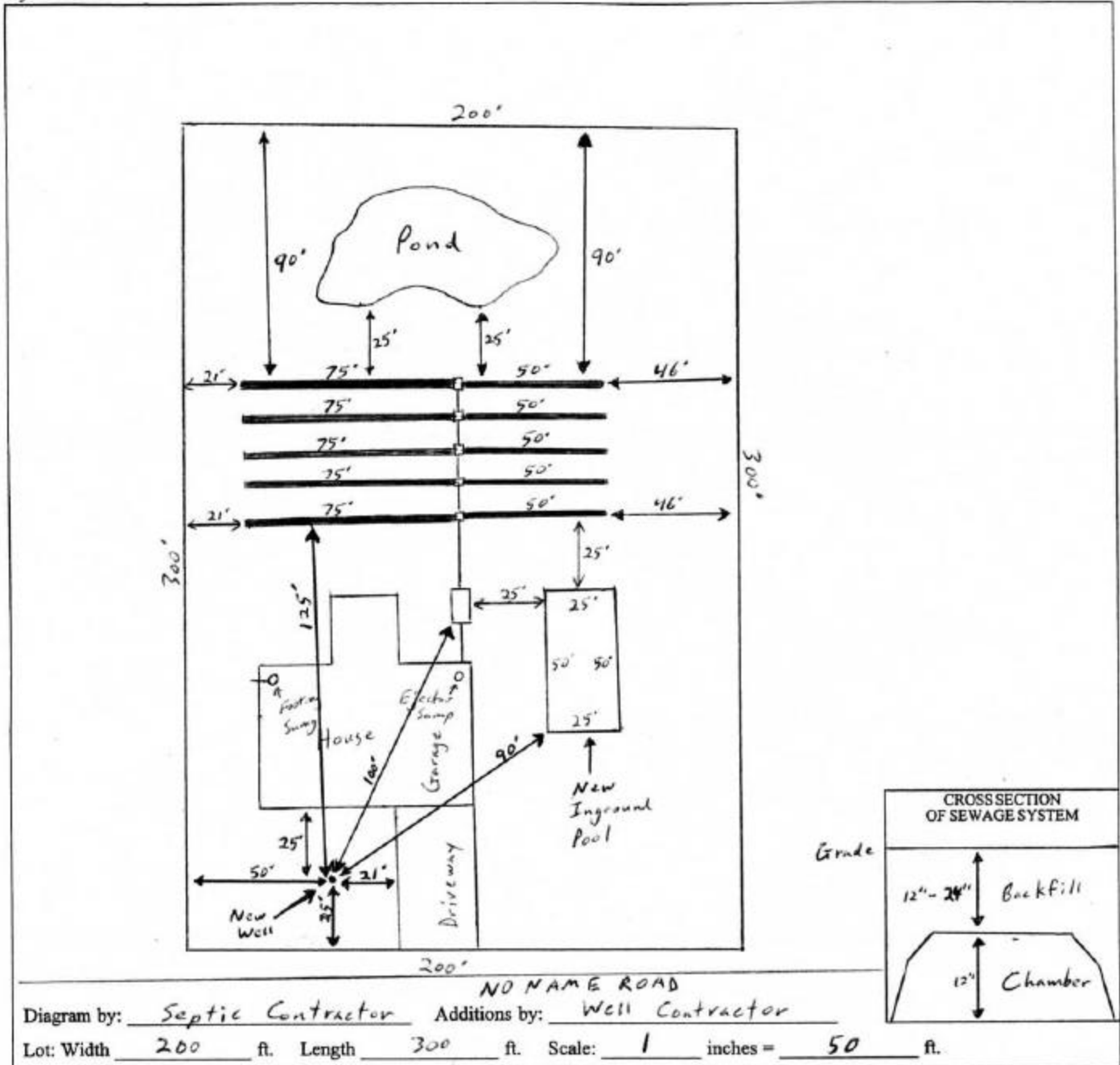

It is clearly understood that the applicant assumes full responsibility for obtaining the inspection and final approval by the Grundy County Health Department on all portions of the sewage disposal installation prior to covering any portion of the system. In requesting an inspection, call (Area Code 815) 941-3128, and give the permit number. Environmental Health Personnel may be on field inspections during the day. Please call to set up an appointment if you wish to see them at the Health Department

I hereby certify that, to the best of my knowledge, the preceding information is correct. In addition, the water supply and sewage disposal system will be installed strictly as outlined in this permit application in conformance with all Grundy County Ordinances and all State of Illinois laws. I further understand the Grundy County Health Department does not guarantee trouble-free operation of this sewage treatment and disposal system by the issuance of a sewage permit or final approval of the sewage installation. The property owner assumes full responsibility for any nuisance or health hazard that might result from its use.

Owner's Signature
 Signature of Applicant

A Grundy County Health Department permit for a sewage treatment or disposal system and or a water supply system to serve the property mentioned herein is hereby granted. Permit expires one year from date of issue.

Application Approved By _____ Date _____

Final Inspection and Approval: Well Ins. By _____ Date _____ Septic Ins. By _____ Date _____

White Conv. - Grundy County Health Dept. Green Conv. - Applicant Canary Conv. - Building Dept. Pink Conv. - Water Survey Goldenrod Conv. - Well Contractor

